

# The Sugartop



## **The Sugartop**

Exceptional one floor design has spacious living area to bring grace and excellence to this home. This three bedroom, two bath home is complete with a two car attached garage.

*Prospect  
Hills*

*Custom homes in as early as 90 days*

[www.prospect-hills.com](http://www.prospect-hills.com)

## The Sugartop

### First Floor

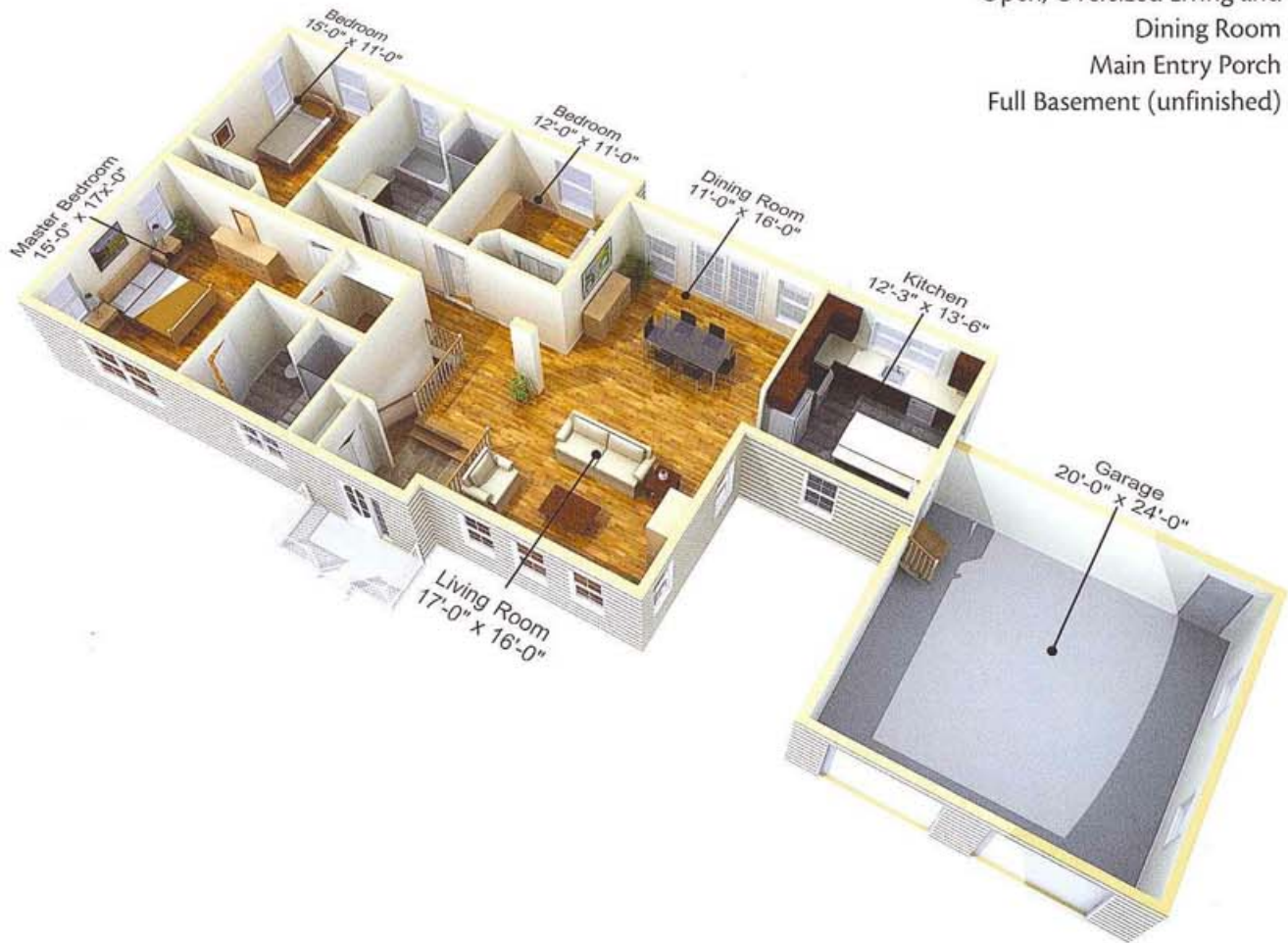

- 3 Bedrooms
- 2 Baths
- 2 Car Garage
- One Floor Living
- Cathedral Ceiling at  
Open, Oversized Living and  
Dining Room
- Main Entry Porch
- Full Basement (unfinished)



M & M Equities, LLC  
386 Plainfield Road  
West Lebanon NH 03784  
Model: 603-448-1950

Conveniently located off Dartmouth  
College Highway/NH Route 4, less than  
a mile east of the Lebanon Green.

[www.prospect-hills.com](http://www.prospect-hills.com)